

**Tyne ARC & Tyne United RC**  
**Course & safety map - 4500m**  
**Tyne LDS (am) and Tyne United SBH (pm)**  
**Event date: 07-10-23** Issued 26-09-23

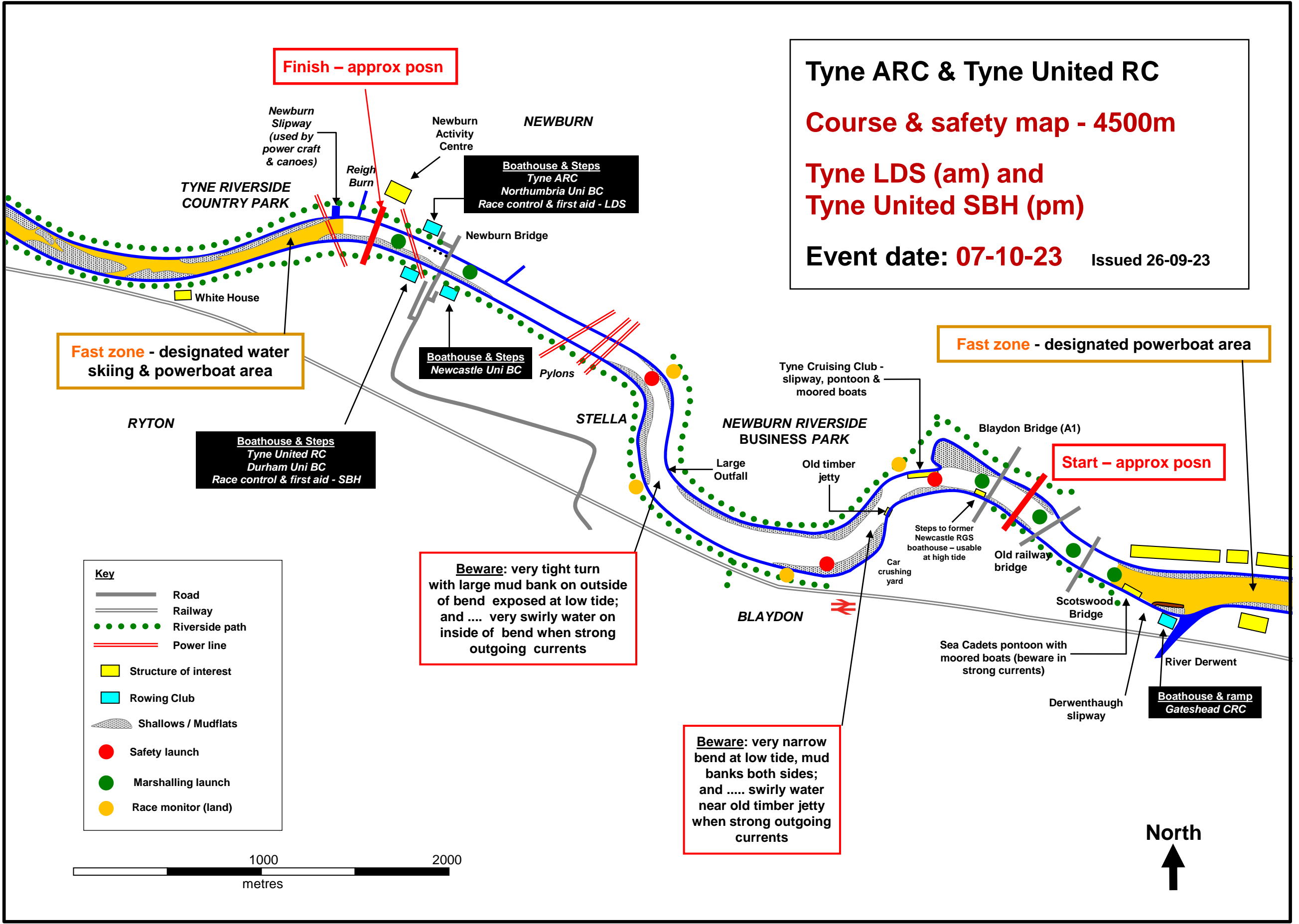

**Finish – approx posn**

**Fast zone - designated water skiing & powerboat area**

**Fast zone - designated powerboat area**

**Start – approx posn**

**Beware: very tight turn with large mud bank on outside of bend exposed at low tide; and .... very swirly water on inside of bend when strong outgoing currents**

**Beware: very narrow bend at low tide, mud banks both sides; and .... swirly water near old timber jetty when strong outgoing currents**

**Key**

	Road
	Railway
	Riverside path
	Power line
	Structure of interest
	Rowing Club
	Shallows / Mudflats
	Safety launch
	Marshalling launch
	Race monitor (land)

